

Panel Mount Membrane Switches - Schurter MCS 18 Series

- Front panel sealed to IP 65 with 'O' ring kit and screw / bracket assembly.
- Positive tactile feel with snap dome.
- Available in 9 colours.
- Bezel removable to insert key ident film.

Specifications:

Contact Resistance: New < 50 mΩ After 10⁶cycles < 150 mΩ
 Switching Voltage: Silver Contact - Min. 5V DC Max. 48V DC
 Switching Current Max.: Silver 125 mA
 Insulation Resistance (pin to pin, off position): >100 MΩ
 Contact Travel: 0.5 ± 0.1mm
 Lifetime (IEC512-5 Test 9a): >1,000,000 operations
 Ambient Temperature: -25 °C to +60 °C.

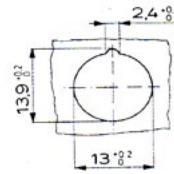

Front panel drilling

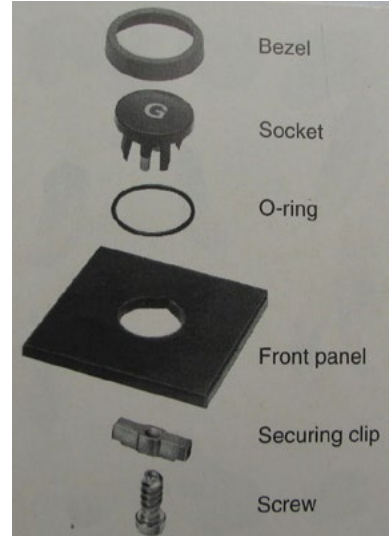
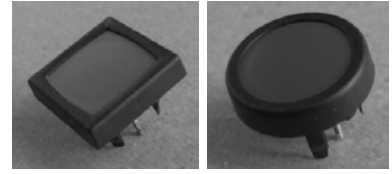

IP65 Seal Kit (O-ring,clip & screw)
 Part No. 41-0098.9201

Part Number Square Black Bezel/Colour Face	Part Number Round Black Bezel/Colour Face
41-1100.791 - Yellow	41-1104.791 - Yellow
41-1100.793 - Red	41-1104.793 - Red
41-1100.795 - Green	41-1104.795 - Green
41-1100.796 - Grey	41-1104.796 - Grey
41-1100.797 - Black	41-1104.797 - Black
41-1100.798 - White	41-1104.798 - White

Panel Mount Metallic Switches - Schurter MCS 19 Series

- Excellent tactile feedback.
- Low profile of 1mm on front panel.
- Protection IP65. – Panel Sealing to IP40.
- Robust metal housing and vandal resistant.
- Easy mounting with M19 nut and sealing ring.

The MCS 19 Metallic is designed for use in front panels or complete enclosures. The switch has mechanical end stop strength, so that the actuator cannot damage the contact element even when hit with hard strokes. The fastening is by a screwed joint and a nut (M19x0.75). The actuator can be zinc diecasting nickel plated or stainless steel. The stainless steel version can be laser-lettered.

Specifications:

Contact Resistance: New < 50 mΩ After 10⁶ cycles < 150 mΩ
 Switching Voltage: Gold: Min. 50mV DC Max. 24VDC
 Silver: Min. 4VDC Max. 48VDC
 Switching Current Max.: Gold: 80 mA Silver: 125mA
 Rated breaking capacity: Gold: 12V/30mA Silver: 24V/50mA
 Actuating Force: 3.7 N Contact Travel: 0.4 mm
 Lifetime (at rated breaking capacity): <1,000,000 operations
 Ambient Temperature: -25 °C to +60 °C.



Std with Solder Aid with Clip

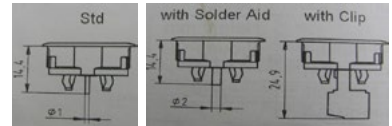

Applications

- Entry control systems
- Door bell equipment
- Vending machines
- POS Info terminals
- Car wash facilities
- Elevator systems
- Test equipment

Variant	Part Number Without Legend		Part Number With Legend	
	Silver	Gold	Silver	Gold
Contacts				
Standard terminals	41-1241.2800	41-1241.2810	41-1241.2805.XXX	41-1241.2815.XXX
With solder aid	41-1241.2801	-	41-1241.2806.XXX	-
With Clip	41-1241.2802	41-1241.2812	41-1241.2807.XXX	41-1241.2817.XXX