

## Finishing Washers

Cover misaligned holes • Protect paintwork • Good insulation properties • High quality finish

Excellent protection against damage. Use as glides, bumpers, feet & spacers.

Part Number	Screw Size	Inside Diameter B	Outside Diameter A	Thickness C
03-FW06	<b>M3 / #6</b>	3.6	11.1	2.5
03-FW06B*	<b>M3 / #6</b>	3.6	11.1	2.5
03-FW08	<b>M4 / #8</b>	4.3	13.0	2.9
03-FW10	<b>M5 / #10</b>	4.9	14.7	3.9
03-FW12	<b>M6 / #12</b>	5.7	15.5	4.1
03-FW25	<b>M6 / 1/4"</b>	6.6	17.4	4.6

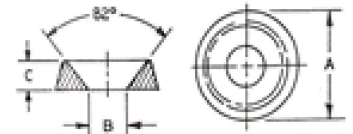
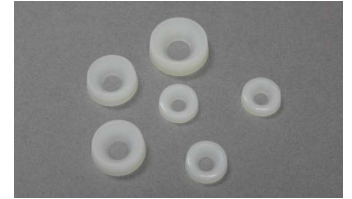

Material: Natural Nylon 6/6

\* = Black Nylon 6/6

Part Number	Head	Type	Size	d	d1	D	h	H
03-FWM4-16PM	Pan	4	<b>M4</b>	4.3	7.0	16.0	3.5	2.3
03-FWM5-11CM	Countersunk	3	<b>M5</b>	5.3	11.0	18.0	3.8	-
03-FWM5-14CM	Countersunk	3	<b>M5</b>	5.3	14.0	18.0	3.5	-
03-FWM5-18PM	Pan	4	<b>M5</b>	5.3	8.5	18.0	4.0	2.7
03-FWM6-22CM	Countersunk	3	<b>M6</b>	6.4	13.0	22.0	4.5	-
03-FWM6-22PM	Pan	4	<b>M6</b>	6.4	10.0	22.0	4.9	3.5



Material: Black Nylon 6/6

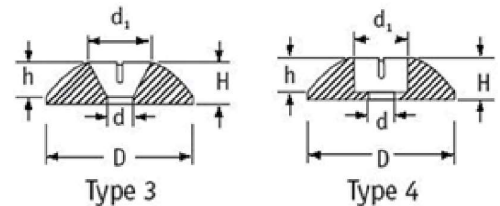

## Countersunk Sleeve Washers

Frequently applied in electro technical environments

• Prevents electrical corrosion with countersunk head screws

Part Number	Screw Size	A	B	C	D	E
03-FW031S	<b>M3</b>	3.1	4.9	8.2	3.7	1.7
03-FW041S	<b>M4</b>	4.1	5.9	10.4	4.3	2.3
03-FW051S	<b>M5</b>	5.1	6.9	12.4	4.8	2.8
03-FW061S	<b>M6</b>	6.1	7.9	14.4	5.3	3.3
03-FW081S	<b>M8</b>	8.1	9.9	18.6	6.4	4.4
03-FW102S	<b>M10</b>	10.2	12.4	22.5	10.3	5.0
03-FW121S	<b>M12</b>	12.1	13.9	26.8	8.5	6.5
03-FW162S	<b>M16</b>	16.2	19.2	35.4	10.8	8.1



Material: Natural Nylon 6 (PA-6)

