

1155 - CT Thermoplastic Handle

Black Reinforced thermoplasticthermoplastic • Plain holes and coloured caps

Part Number	A	L	B	d	C	h1
11-HPB093H6	93±1	116	35	6.5	20	20
11-HPBX093H6	93±1	116	35	6.5	20	20
11-HPB109H8	109±1	141	42	8.5	25	20
11-HPBX109H8	109±1	141	42	8.5	25	20
11-HPB117H8	117±1	141	42	8.5	25	20
11-HPBX117H8	117±1	141	42	8.5	25	20
11-HPB132H8	132±1	163	45	8.5	29	22
11-HPBX132H8	132±1	163	45	8.5	29	22
11-HPB150H8	150±1	181	48	8.5	31	25
11-HPBX150H8	150±1	181	48	8.5	31	25

Part no. 11-HPB093H6 = with Black caps

Part no. 11-HPBX093H6 X = Cap colour : B – Blue cap , O – Orange, R – Red, Y – Yellow, G - Grey

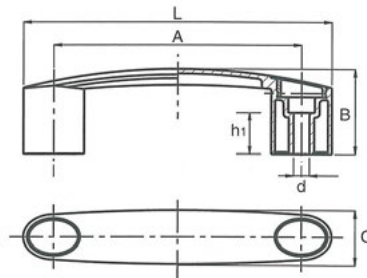

1156 - MGM Thermoplastic Handle

Black or Orange thermoplastic ends • Center piece anodised aluminium

Part Number	D	L	A	B	C	H	h1	h2	d
11-HMBAL20020H8	20	200±1	47	23	26	53	40	6	8.4
11-HMOAL20020H8	20	200±1	47	23	26	53	40	6	8.4
11-HMBAL20025H8	25	200±1	56	29	32	60	43	8	8.4
11-HMOAL20025H8	25	200±1	56	29	32	60	43	8	8.4

L – also available in lengths – 300, 400, 500,700

11-HMBBRKT20 – Handle bracket only black 20mm dia

11-HMBBRKT25 – Handle bracket only black 25mm dia

11-HMBAL = black 11-HMOAL = orange

